

This drawing is copyright of Sharpe Topping LTD and must not be copied or reproduced in anyway without written consent.  
 DO NOT SCALE OFF THIS DRAWING

- NOTES:
1. This drawing is to be read in conjunction with all relevant Architects and Engineers Drawings.
  2. It is assumed that all works will be carried out by a competent contractor working, where appropriate, to an approved method statement.

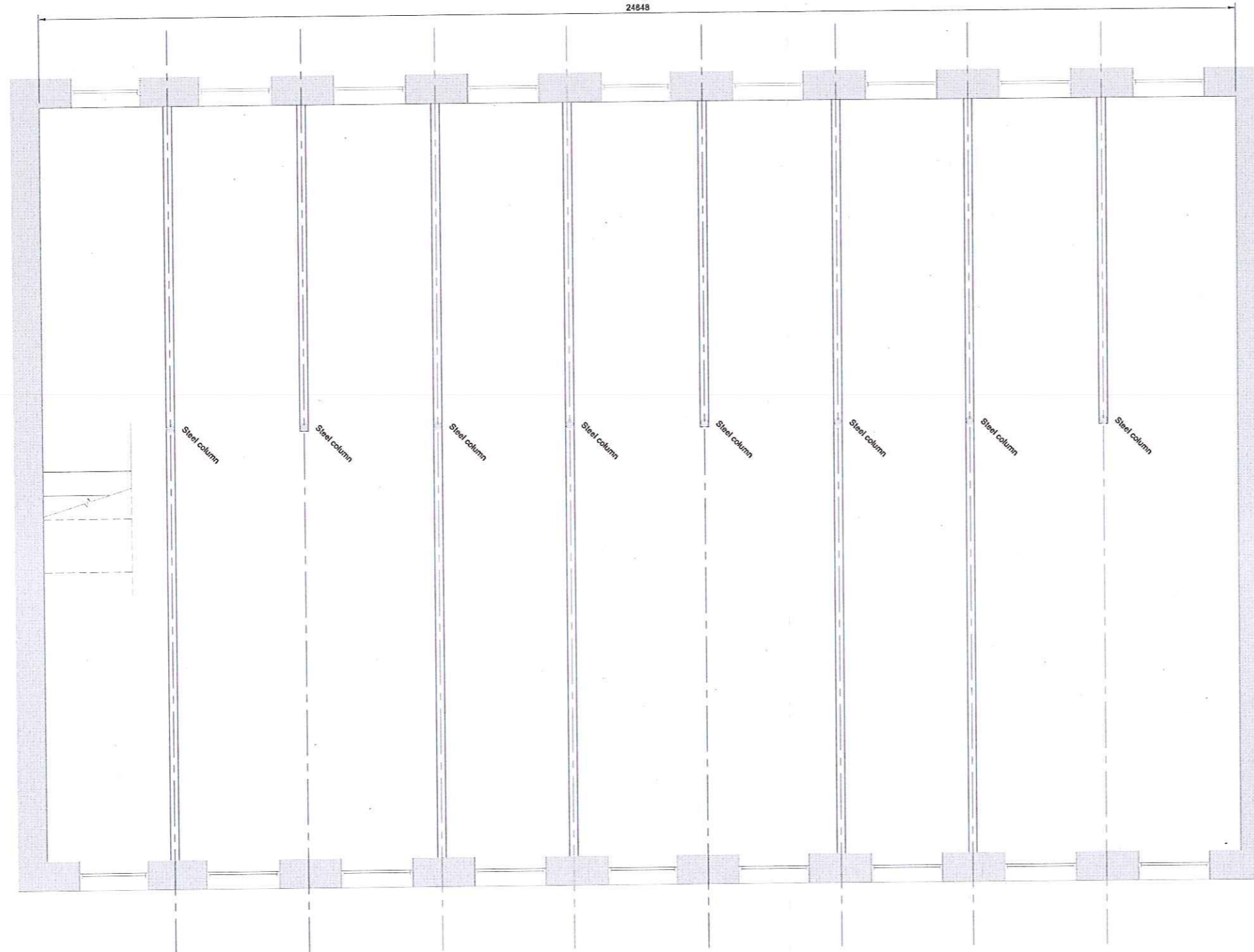

EXISTING SECOND FLOOR PLAN  
 Scale 1:50

CDM HAZARDS		
It is assumed that all works will be carried out by a competent contractor working, where appropriate, to an approved method statement.		
In addition to the Hazards/Risks normally associated with the types of work detailed on this drawing, note the following:		
No.	Activity	Method

No.	Revision	Date	Drawn

Status: APPROVAL

**SHARPE-TOPPING**  
 STRUCTURAL ENGINEERS  
 Windsor House | Cornwell Road | Harrogate | HG1 2PW  
 t: 01423 522 293 e: 05501 149 377  
 i: info@sharpe-topping.com w: www.sharpe-topping.com

Client: EDWIN WOODHOUSE

Project: THE OLD WOOLLEN,  
 SUNNYBANK MILLS

Drawing title: EXISTING SECOND FLOOR GA

Drawn	Chkd	Date	Scale
GH	CAS	11/11/11	1:50
Contract No	Dir No	Revision	
13100	S03	-	